



## Daunara Safari Camp Facts & Information

Daunara Safari Camp is set on a pristine island in the world-famous Okavango Delta. Our owner-run camp promises to deliver next-level, bespoke experiences for guests. The four suites overlook a permanent lagoon filled with hippos, and elephants are almost constant visitors to the surrounding floodplains.

Enjoy farm-to-table style meals prepared by a private chef in this perfect home-away-from-home.

Guests leave feeling like they have made a new family, having deeply connected with Botswana, its people and its wildlife; experiential luxury in the true sense of the word is felt through a human connection.

Daunara Safari Camp works closely with the surrounding communities on multiple levels, ensuring the economic benefits of the tourism industry create positive social upliftment.

info@daunarasafaricamp.com | daunarasafaricamp.com

### Key Facts:

- Exclusive Use
- 3 x Suites + 1 x Family Suite
- Small & Intimate – Maximum 10 guests
- Owner Run

### Access:

- 25 minute Scenic Helicopter Flight from Maun
- Alternatively, 2-hour road transfer from Maun
- The helicopter landing site is 1km from camp. Guests will be collected in game viewers and driven to camp upon arrival.

### Location:

- Southern Okavango
- 125 thousand hectares
- Coordinates: 19°44'53.61"S 23°27'17.97"E

### When to visit:

- Opened 2024
- Daunara Safari Camp will be open all year round

### Camp Layout

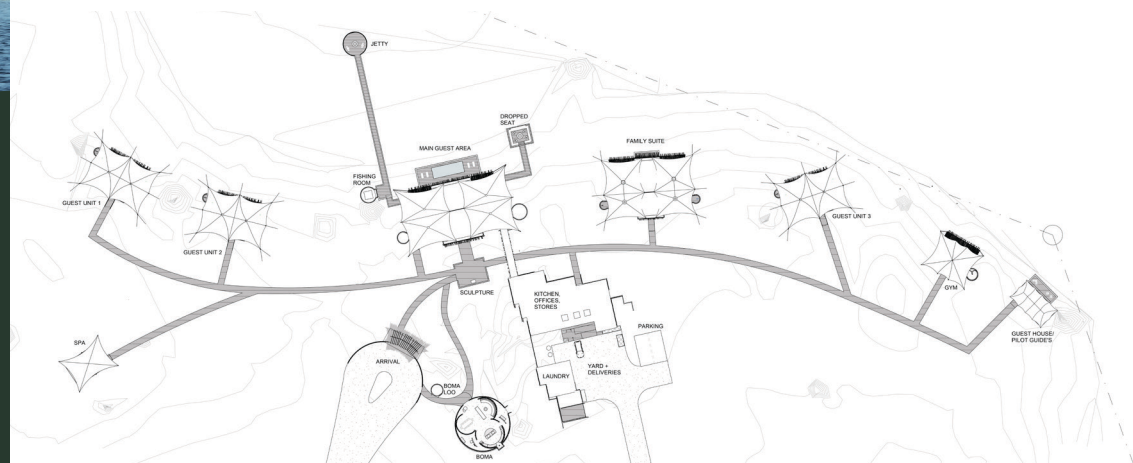



## What to Expect:

### Suite Amenities:

- Airconditioning  
2x per Suite; 4x in Family Suite)
- Amenities tray
- Hairdryer
- Minibar

### Suite Sizes:

#### Guest Suite

- Internal: 70sqm
- External: 50sqm (including portico)

#### Family Suite

- 2 Bedroom Suite (Identical bedrooms with en suite bathrooms)
- Internal: 185sqm
- External: 105sqm (including portico)

#### Pilot Guide Room

- Internal: 50sqm
- External: 30sqm

### Main Area:

- Boma
- Dining Area (Indoor & outdoor)
- Gym
- Lounge
- Spa
- Swimming Pool
- Wine Cellar

### Dining:

- Private Chef
- Farm to table style dining
- All dietary requirements can be accommodated for if we are alerted upon the time of booking

### Vehicles:

- 3x Land Cruisers
- USB Ports
- Led lights
- Fold down sides



## Rates:

### Rates are fully inclusive.

Private vehicle & guide, all meals, dedicated chef and host, daily activities (NB there are some exclusions), local drinks and laundry are included.

Flights, discretionary tips/gratuities, items of a personal nature and personal travel insurance are excluded.

## Activities:

Morning and afternoon game drives

Night game drives

Enjoy incredible bird watching

Boating and Mokoro safaris \*

Champagne & Picnic stop \*\*

Helicopter flights over the Okavango Delta and to view ancient rock paintings \*\*

Spa treatment \*\*

Astronomer \*\*

Relaxing around the swimming pool

Catch & Release Fishing \*\*\*

Head out by heli on a community visit to meet with some of our community based outreach partners in the nearby villages. You'll also spend time with one of our conservation partners to see first-hand how together we are able to make a difference to wildlife conservation in the area \*\*

\* During low water season from April - January, mokoro & boating may be limited as these activities are subject to water levels.

\*\* At an additional cost

\*\*\* Seasonal: April - December

Please see activities on Rate sheet for more information.

Children of all ages welcome.

DAUNARA

info@daunarasafaricamp.com | daunarasafaricamp.com